

MODEL 3000 FLAT BED BALE LOADER INSTALLATION INSTRUCTIONS

- 1) Remove box from truck.
- 2) Cut truck frame to length. Measure from front of bed to backside of license plate panel. (Fig 1)(Save removed pieces for future Replacement)
- 3) Measure fuel filler tube if it is above the frame and make sure there is $\frac{1}{2}$ " clearance above it.
- 4) Lay Straight edge along and parallel to truck frame rail

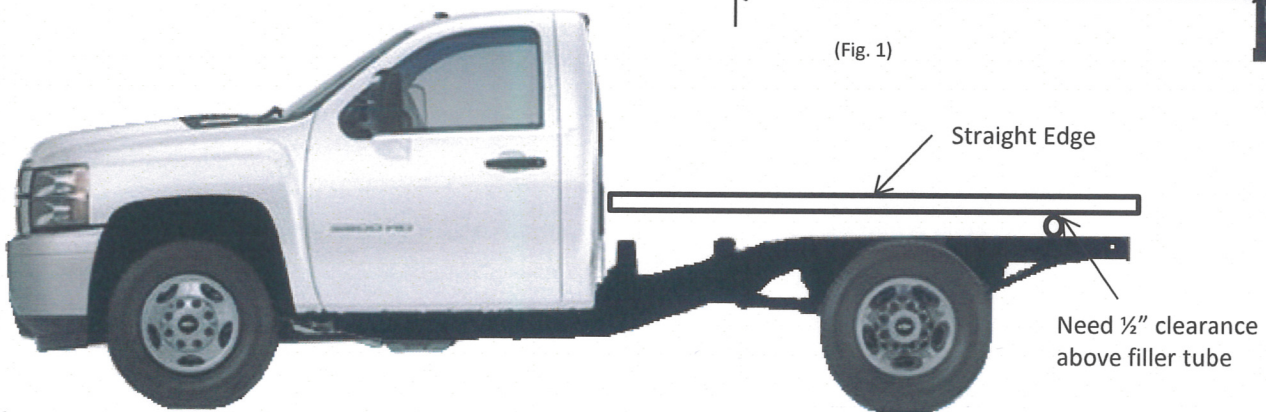
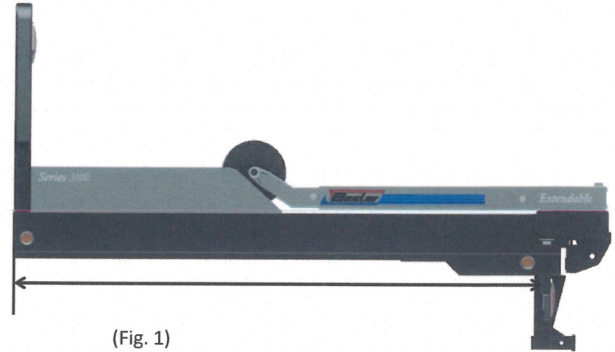

- 5) Center 2" x 3" tube at the front set of existing box mounting holes. (Point A)

NOTE: If truck frame rails are over 38" wide, 2" x 3" tubes must be provided by the installer.

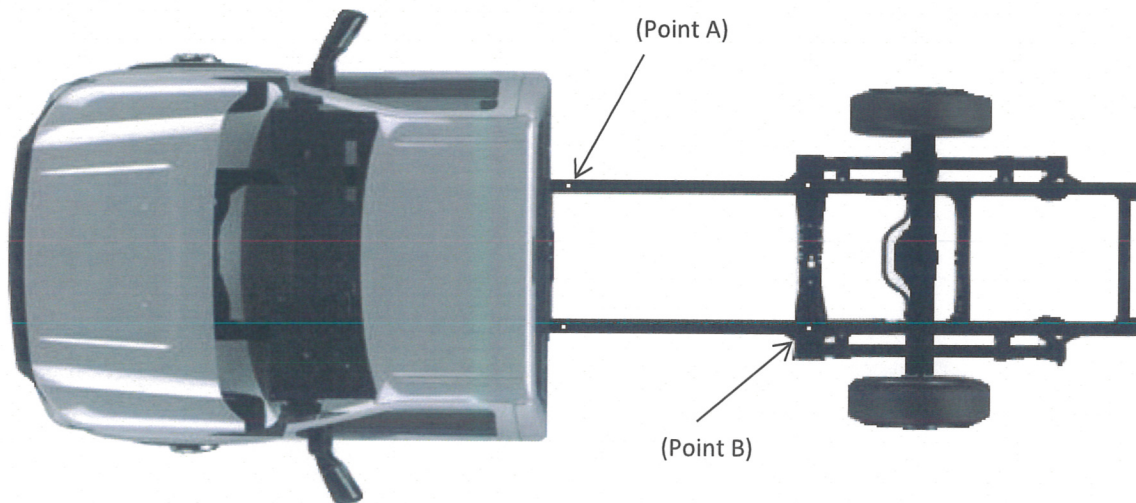

- 6) Drill tube to match existing holes in truck frame (5/8" Diameter)
- 7) Repeat Steps 5 & 6 for the 2" x 3" for (Point B)
- 8) Bolt tubes to truck frame rails using 5/8" x 1-1/2" bolts, lockwashers, washer and nuts. (Fig 2)
- 9) Add Shims to the top of tubes to get the straight edge parallel and level to truck frame. (Fig. 3)

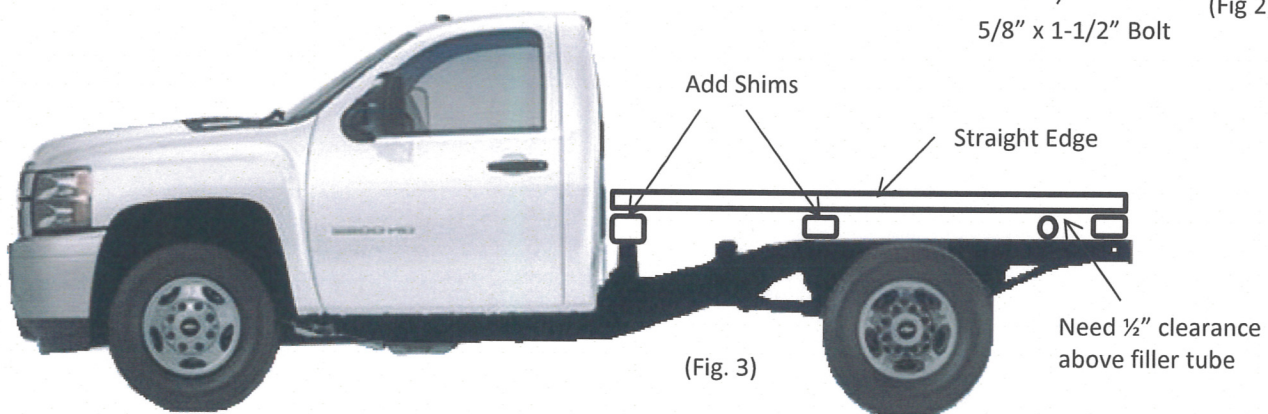
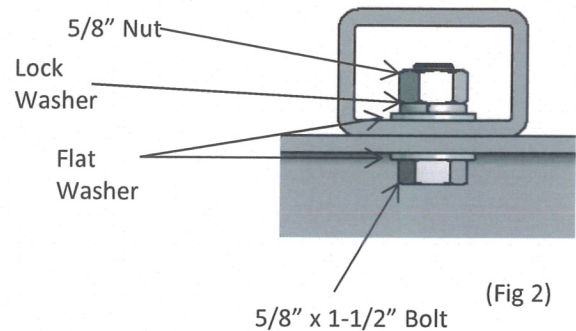

- 10) Double check clearance for fuel filler tube.
- 11) Weld Shims all around on top of crosstubes
NOTE: All welding should be done by a qualified professional.
- 12) Center Flat bed on truck leaving 1" to 2" from back of cab to front of flat bed. (Fig. 4)
- 13) Check side to side for exact measurement.

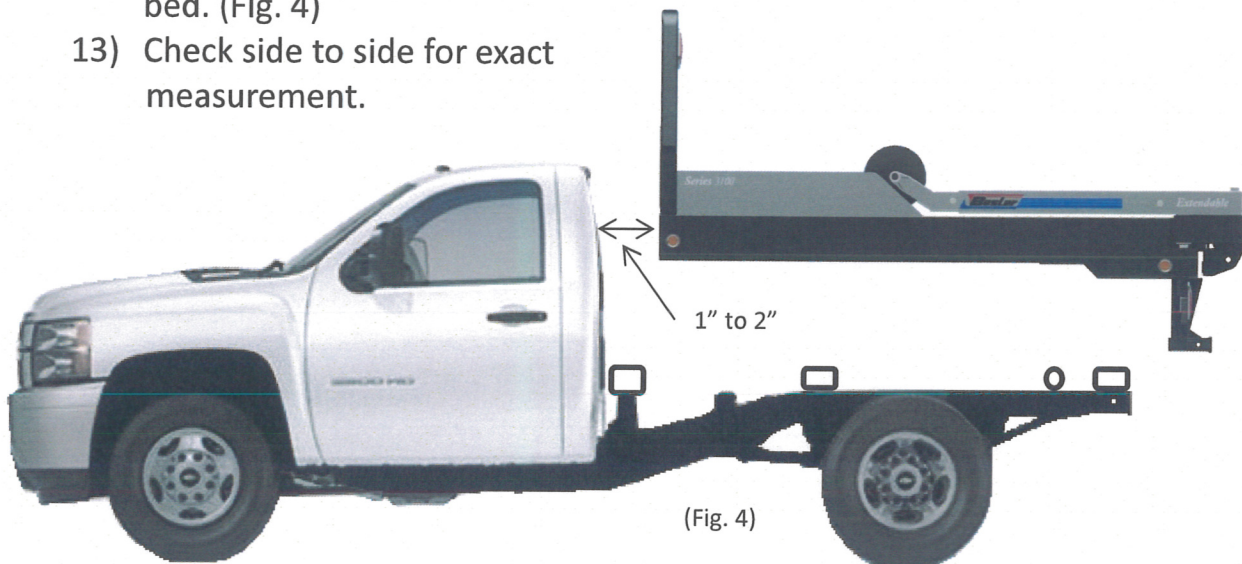

14) Double check all measurements and clearance

- Check cab to front of bed
- Fuel Filler Clearance
- Hydraulic Pan to truck frame

15) Bolt Angles to existing holes in truck frame (Point C)

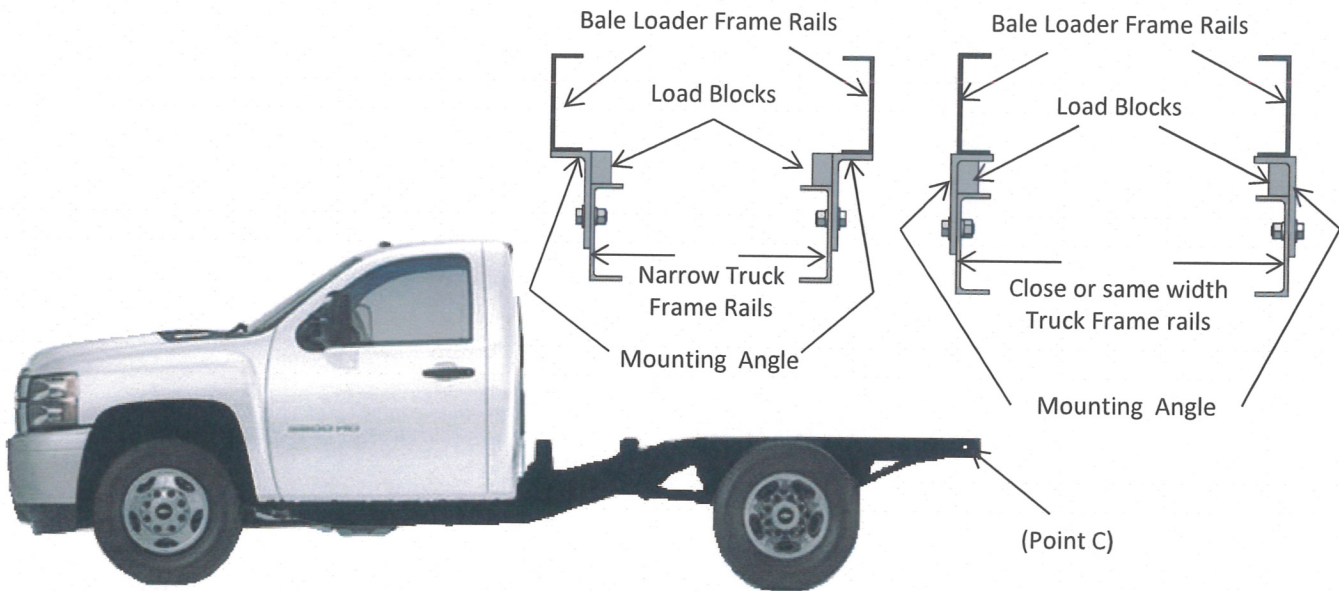

16) Cut load blocks to length and clamp to mounting angle. Load blocks will carry all of the weight of flat bed and cargo when properly installed.

17) Weld Load Blocks to mounting angles, weld angles to flat bed rails.

CAUTION: DO NOT WELD ANY PART OF THE FLAT BED TO THE TRUCK FRAME RAILS.

18) Weld front tubes and shims to flat bed rails.



Upgraded Features

5th Wheel Ball

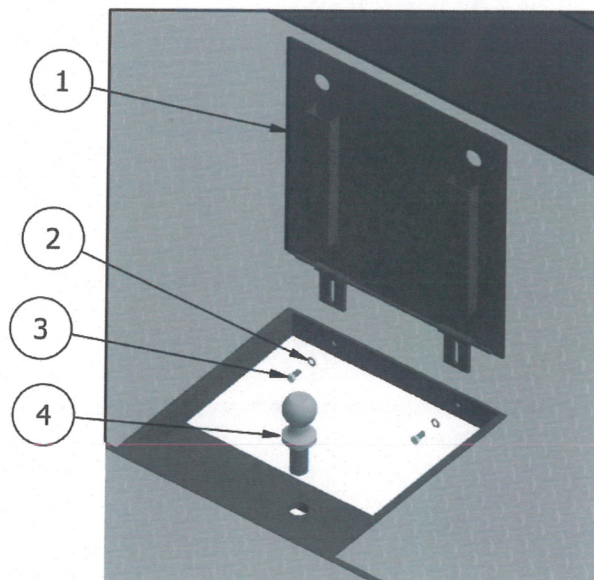

Headache Rack Additions

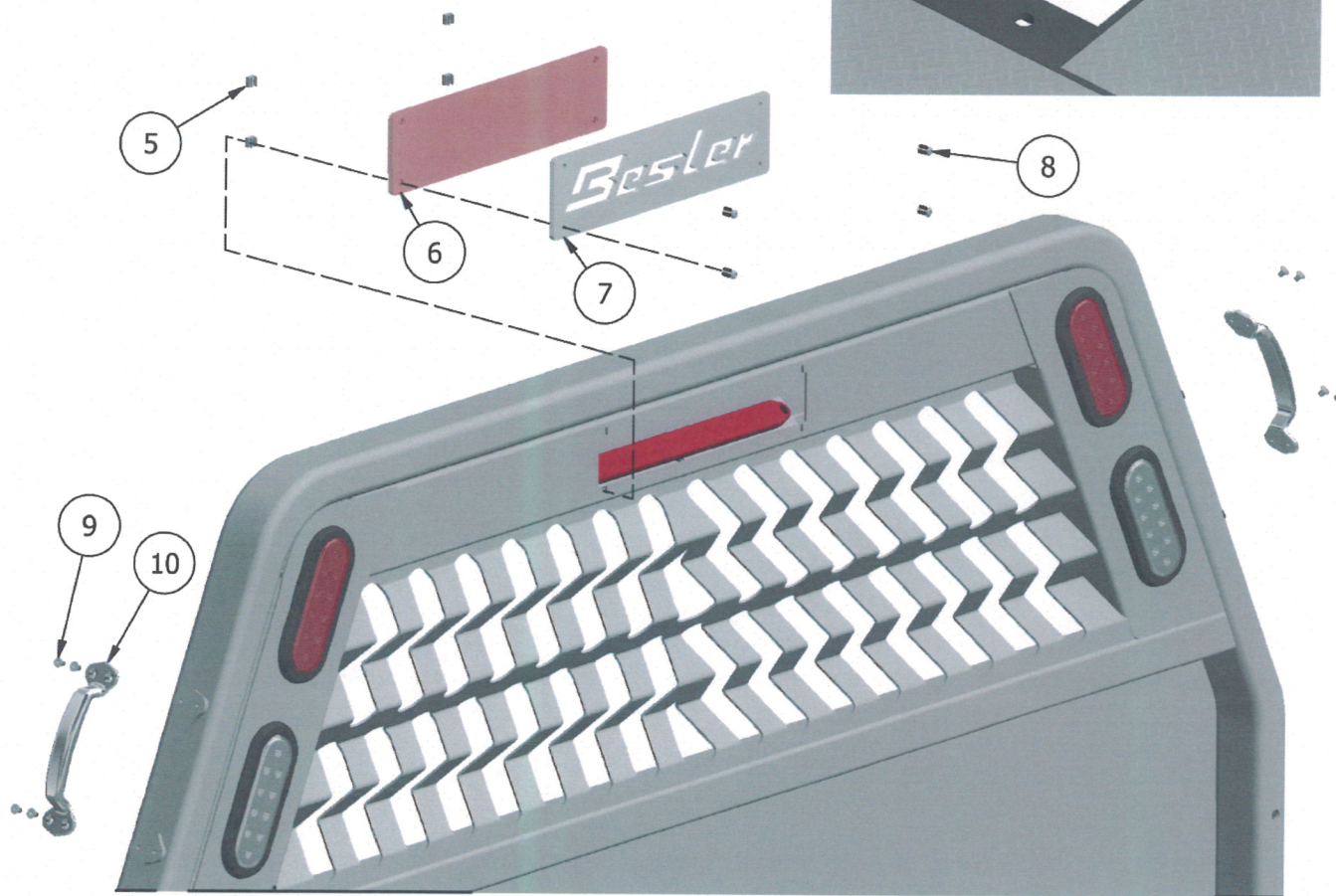

TABLE

I.D.	Part #	Description	Qty	I.D.	Part #	Description	Qty
1	13532	5th Wheel Door Assembly	1	6	17802	Red Plastic Lens	1
2	90224	3/8" Flat Washer	2	7	17801	Besler Logo Plate	1
3	90119	3/8" x 3/4" Bolt	2	8	17800	1/4" x 5/8" Allen Head Bolt	4
4	10704	2-5/16 x 1-3/8" x 1" Raised Ball	1	9	17421	1/4" Flanged Head Screw	8
5	17803	1/4" Cage Nut	4	10	17693	Chrome Grab Handle	2