



STACKFOLD TOOLBAR



Besler Industries Inc.
40855 West Hwy 6&34
Cambridge Ne. 69022



Phone: (308)-697-4698

Fax: (308)-697-4747

Website: beslerindustries.com

SAFE OPERATION



AVOID ELECTROCUTION. Be aware of overhead power lines. Contact or close proximity to power lines can result in injury or death. Use extreme care when operating implement near power lines.



AVOID ROLLOVER. Do not fold or unfold implement when on uneven ground. Avoid making sharp turns on uneven ground, as the shift of weight could cause rollover. Operate implement at a safe distance from terrain irregularities and other obstructions that could cause rollover.



AVOID CRUSHING. Make sure all personnel are clear of implement at all times implement is in motion. Be aware of obstructions above, below and around implement when in operation or transport. Serious injury or death can result from being struck by the implement or attachments.



NO RIDERS. NEVER ALLOW RIDERS ON TRACTOR OR IMPLEMENT.

Riders hinder operator visibility and can be thrown from the implement and/or be struck by foreign objects resulting in injury or death.



HIGH PRESSURE FLUID HAZARD. To prevent serious injury or death. Relieve pressure on hydraulic system before servicing or disconnecting hoses. Wear proper hand and eye protection when searching for leaks. Keep all components in good repair.



USE PARKING STANDS TO SUPPORT IMPLEMENT. Store implement on a clean, dry, and level surface. An uneven surface could cause implement to shift or fall, resulting in injury or death, as well as implement damage. Securely support all implement components that must be raised.

SAFETY WARNING LOCATIONS



High Pressure Fluid Hazard
Should be located
Near the hydraulic
Hoses in highly visible
Area, that can easily
Be seen from the front
Of the toolbar

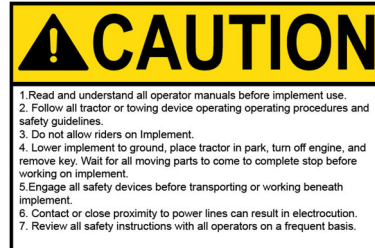

CAUTION
Should be located
Near the hydraulic
Hoses in highly visible
Area, that can easily
Be seen from the front
Of the toolbar

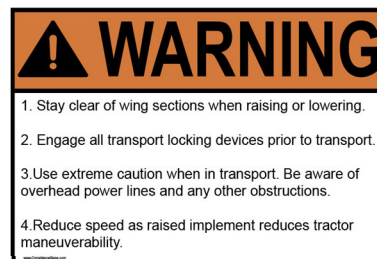
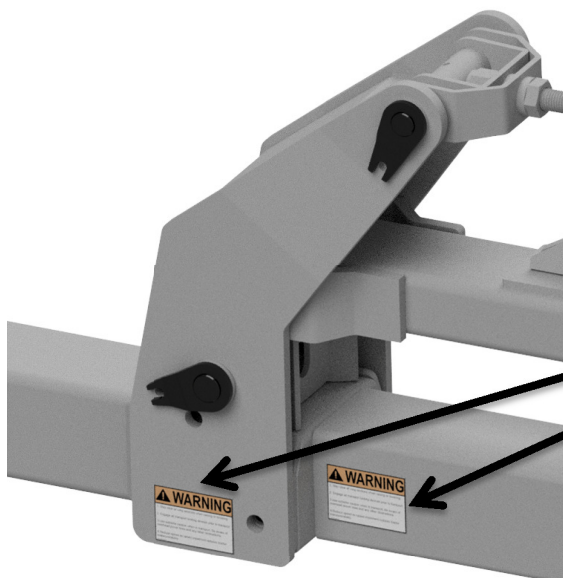
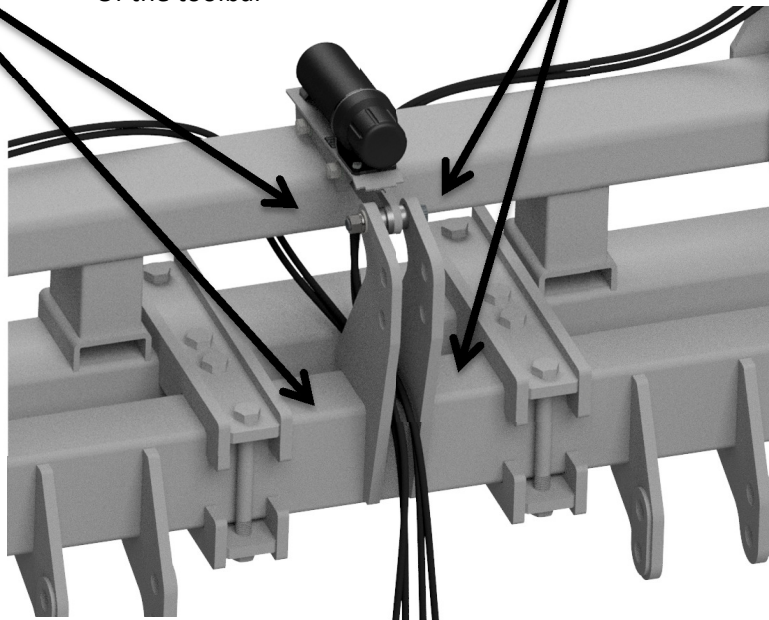

Warning
Should be located On the bottom
outside of the wing , on Both the
Front and back of the bar. There
Should also be warning signs on both
Front and back of the center bar so it
Is readable when the wings are folded

Parking Stand Complete Assy

36" - 14212 48" - 16343

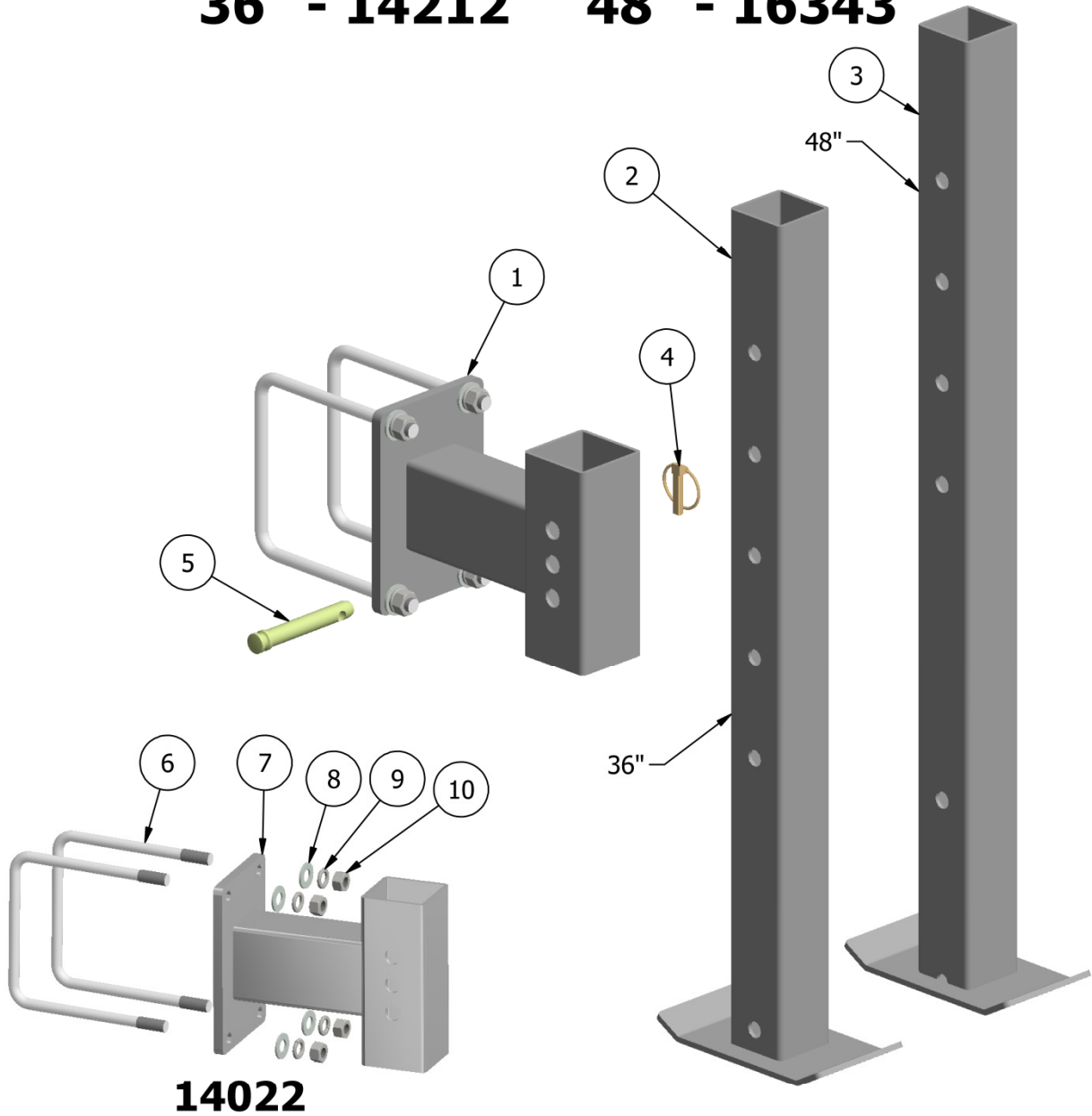

ITEM	PART #	DESCRIPTION	QTY	ITEM	PART #	DESCRIPTION	QTY
1	14022	Stand Reciever	1	6	90143	U-bolt 5/8" x 7-1/8"	2
2	14211	Parking Stand 36"	1	7	14023	Parking Stand Receiver	1
3	14210	Parking Stand 48"	1	8	90124	5/8" Flat Washer	4
4	90115	Lynch Pin 7/16" x 1-1/2"	1	9	90123	5/8" Lock Washer	4
5	14114	cat 1 pin	1	10	90137	5/8" Nut	4

EXPLODED VIEW

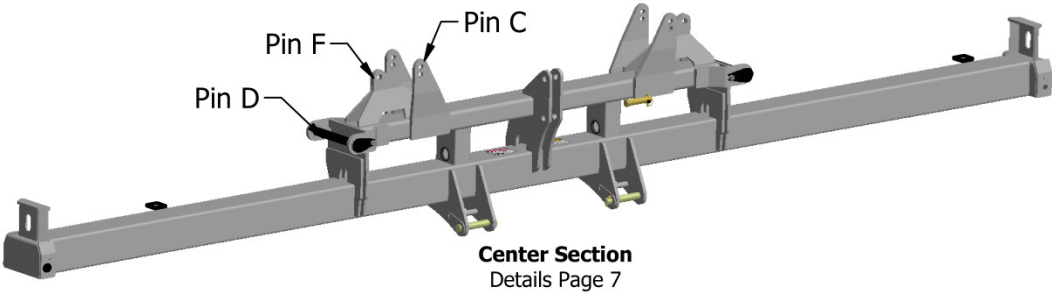
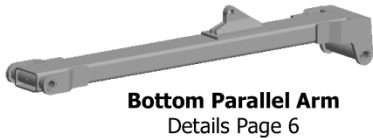
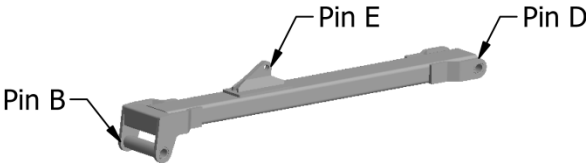
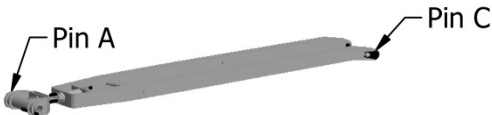
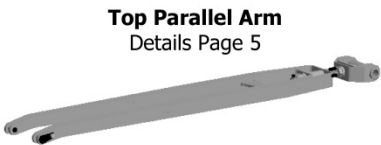
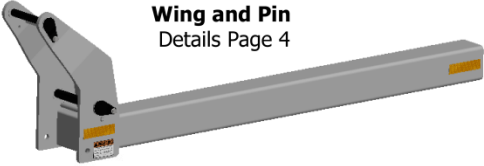
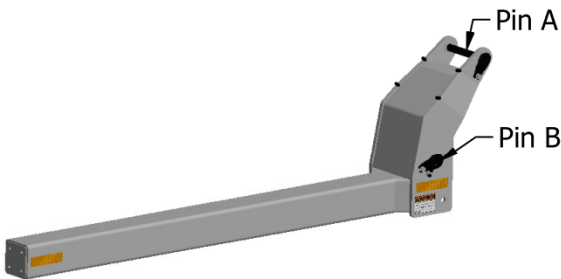

WING DETAILS

Left & Right are the same

PLANTER WING PART #	
MODEL	PART #
12 R 30	16051
12 R 32	16424
12 R 36	16047
12 R 38	16045
12 R 40	16053
16 R 30	16055
16 R 36	16057

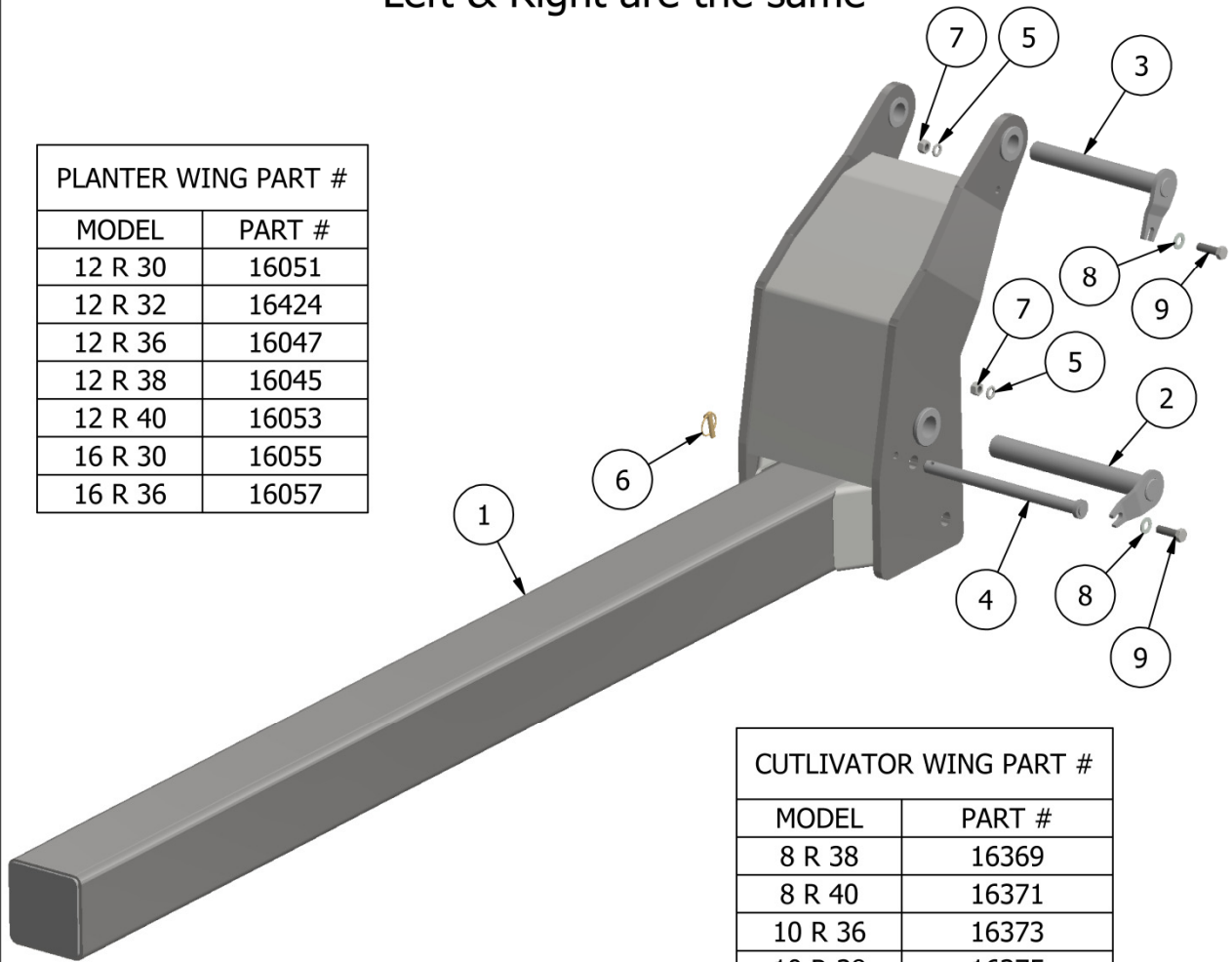

CUTLIVATOR WING PART #	
MODEL	PART #
8 R 38	16369
8 R 40	16371
10 R 36	16373
10 R 38	16375
12 R 30	16377
12 R 36	16379
12 R 38	16381
12 R 40	16383
15 R 30	16387

ITEM	PART #	DESCRIPTION	QTY	ITEM	PART #	DESCRIPTION	QTY
1		SEE ABOVE CHARTS		6	90115	Lynch Pin 7/16" x 1-1/2"	1
2	17409	Center Arm - Wing Pin	1	7	90137	5/8" Nut	2
3	11954	Wing Top Pin	1	8	90124	5/8" Flat Washer	2
4	17222	Lock Shaft	1	9	90161	5/8" x 2" Bolt	2
5	90123	5/8" Lock Washer	2				

TOP PARALLEL ARM

Left & Right are the same

PLANTER ARM PART #	
MODEL	PART #
12 R 30	16079
12 R 32	16079
12 R 36	17426
12 R 38	11962
12 R 40	11962
16 R 30	11962
16 R 36	11962

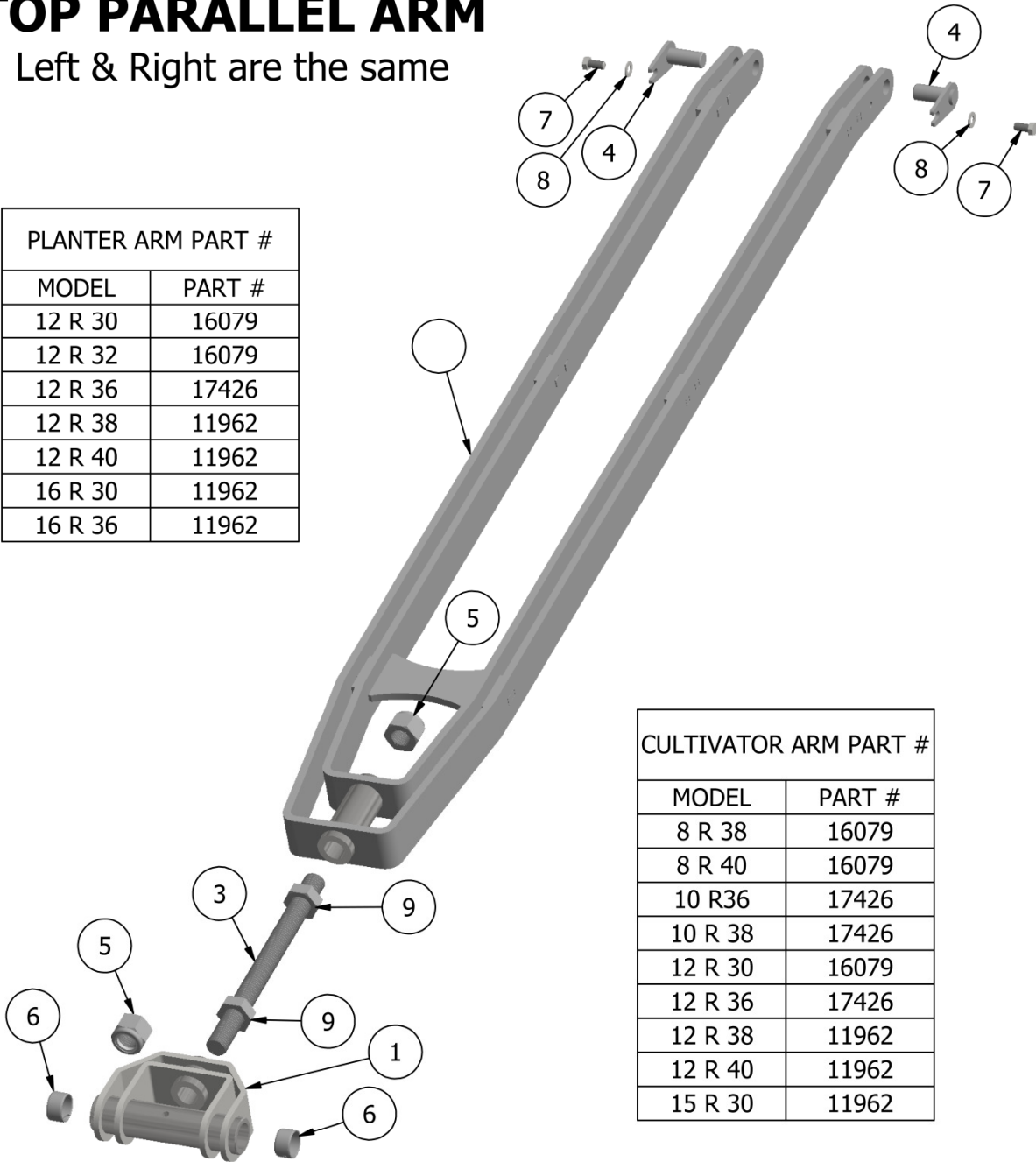

CULTIVATOR ARM PART #

MODEL	PART #
8 R 38	16079
8 R 40	16079
10 R36	17426
10 R 38	17426
12 R 30	16079
12 R 36	17426
12 R 38	11962
12 R 40	11962
15 R 30	11962

ITEM	PART #	DESCRIPTION	QTY	ITEM	PART #	DESCRIPTION	QTY
1	16268	Wing Pull Yoke	1	6	16076	1-3/4" x 1-1/2" x 1" Bushing	2
		SEE ABOVE CHARTS		7	14213	1/2" x 1 bolt	2
3	16328	Guide arm adjustment bolt	1	8	90131	1/2" Flat Washer	2
4	16341	guide arm small pin assy	2	9	90446	1-3/8" Jam Nut	2
5	90445	1-3/8" Nylock Nut	2				

BOTTOM PARALLEL ARM

Left & Right are the same

PLANTER ARM PART #	
MODEL	PART #
12 R 30	16011
12 R 32	16011
12 R 36	16044
12 R 38	16116
12 R 40	16116
16 R 30	16116
16 R 36	16116

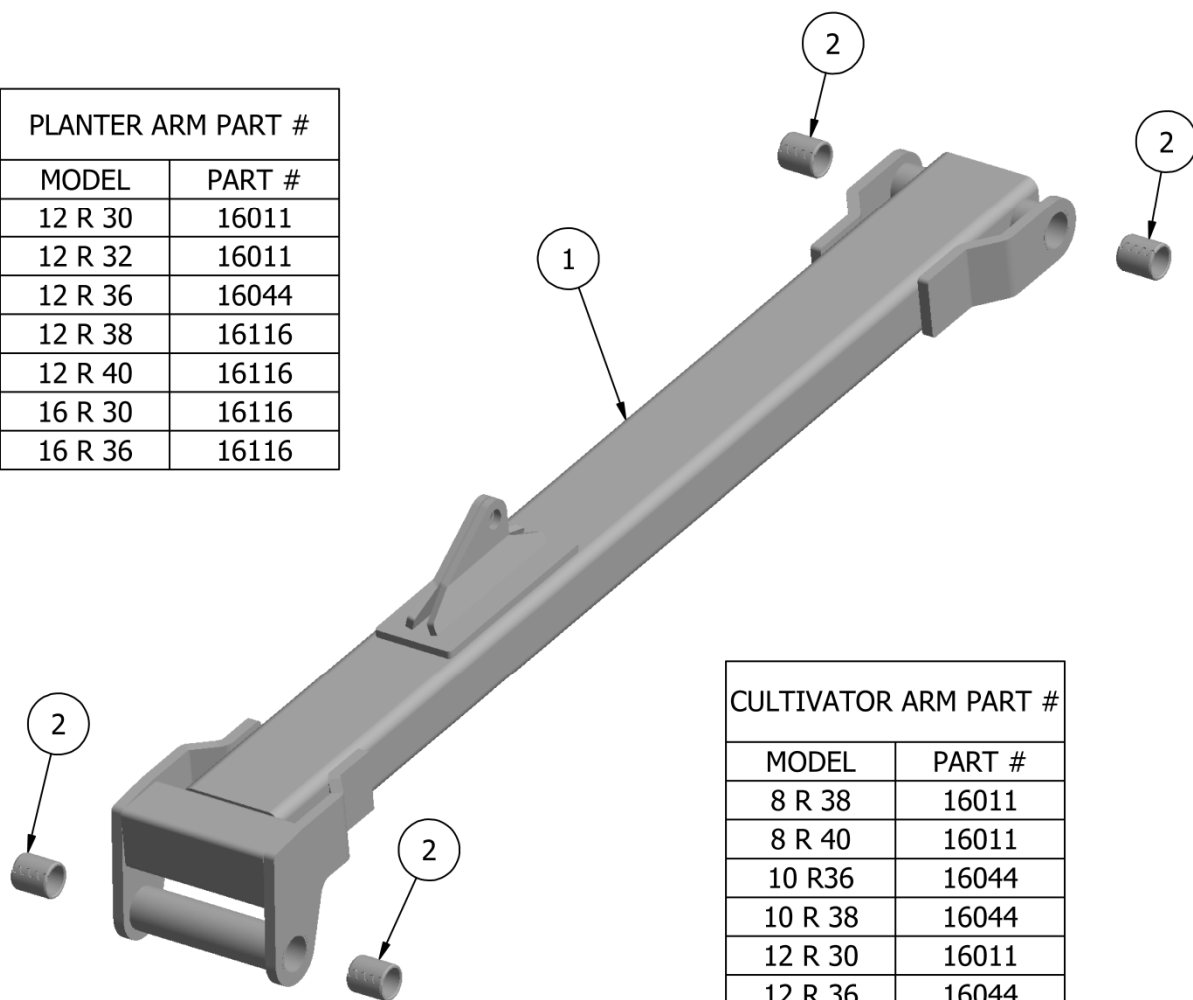

CULTIVATOR ARM PART #	
MODEL	PART #
8 R 38	16011
8 R 40	16011
10 R36	16044
10 R 38	16044
12 R 30	16011
12 R 36	16044
12 R 38	16116
12 R 40	16116
15 R 30	16116

ITEM	PART #	DESCRIPTION	QTY	ITEM	PART #	DESCRIPTION	QTY
1		SEE ABOVE CHARTS		2	16077	2-1/4 x 1-3/4 x 2-1/2 Bushing	4

STACK FOLD CENTER SECTION

PLANTER CENTER PART #

MODEL	PART #
12 R 30	16074
12 R 32	16013
12 R 36	16012
12 R 38	16000
12 R 40	16000
16 R 30	16015
16 R 36	16016

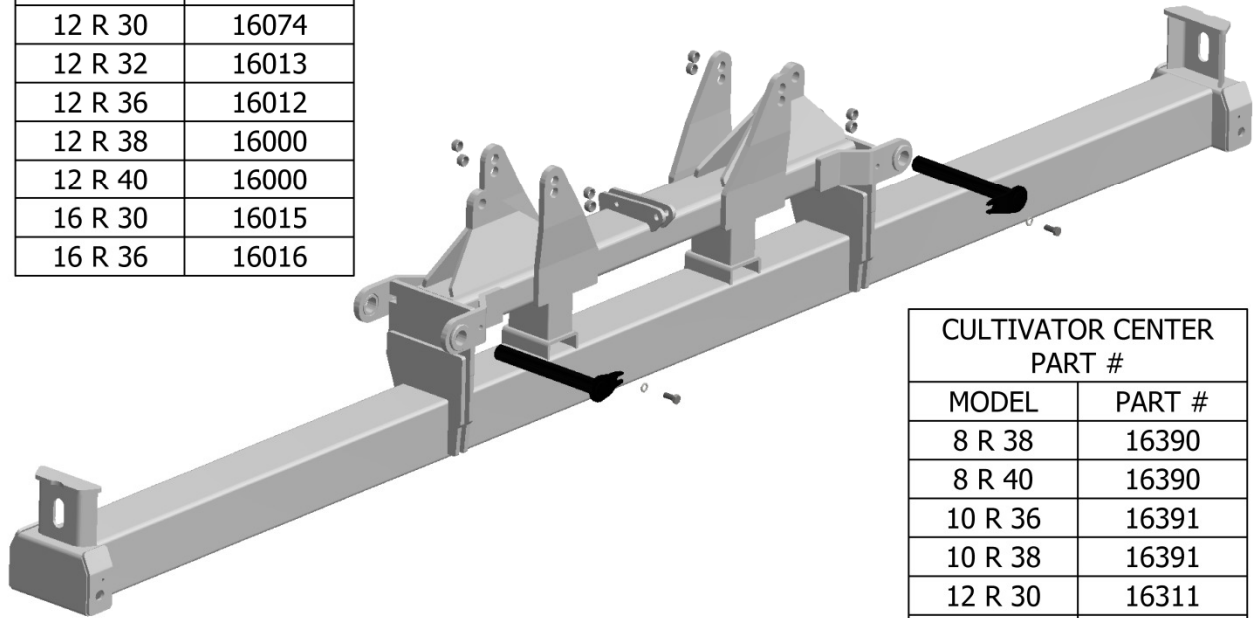

CULTIVATOR CENTER PART #

MODEL	PART #
8 R 38	16390
8 R 40	16390
10 R 36	16391
10 R 38	16391
12 R 30	16311
12 R 36	16393
12 R 38	16394
12 R 40	16395
15 R 30	16396

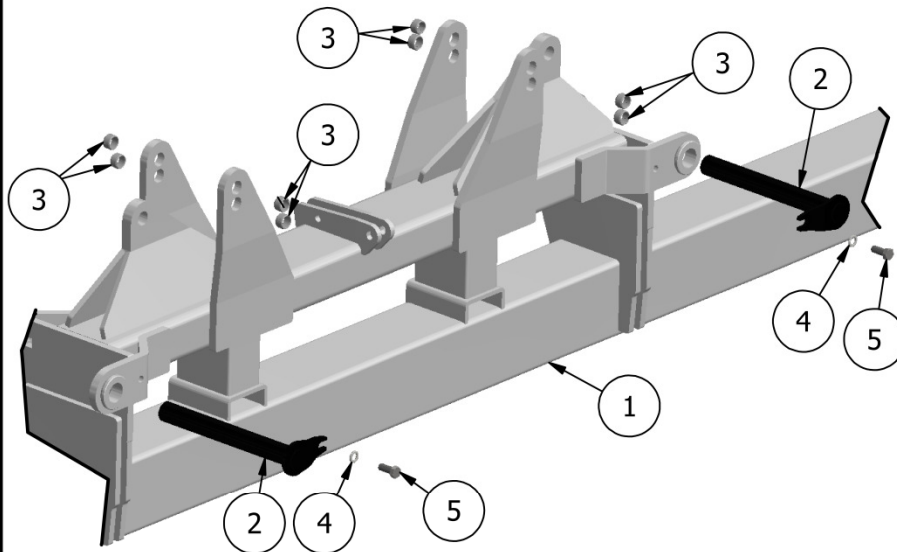

ITEM	PART#	DESCRIPTION	QTY	ITEM	PART#	DESCRIPTION	QTY
1		SEE ABOVE CHARTS	1	4	90123	5/8" Lock Washer	2
2	17409	Center Arm - Wing Pin	2	5	90153	5/8" x 1-1/2" Bolt	2
3	16075	1-1/4 x 1 x 3/4 Bushing	8				

HYDRAULICS

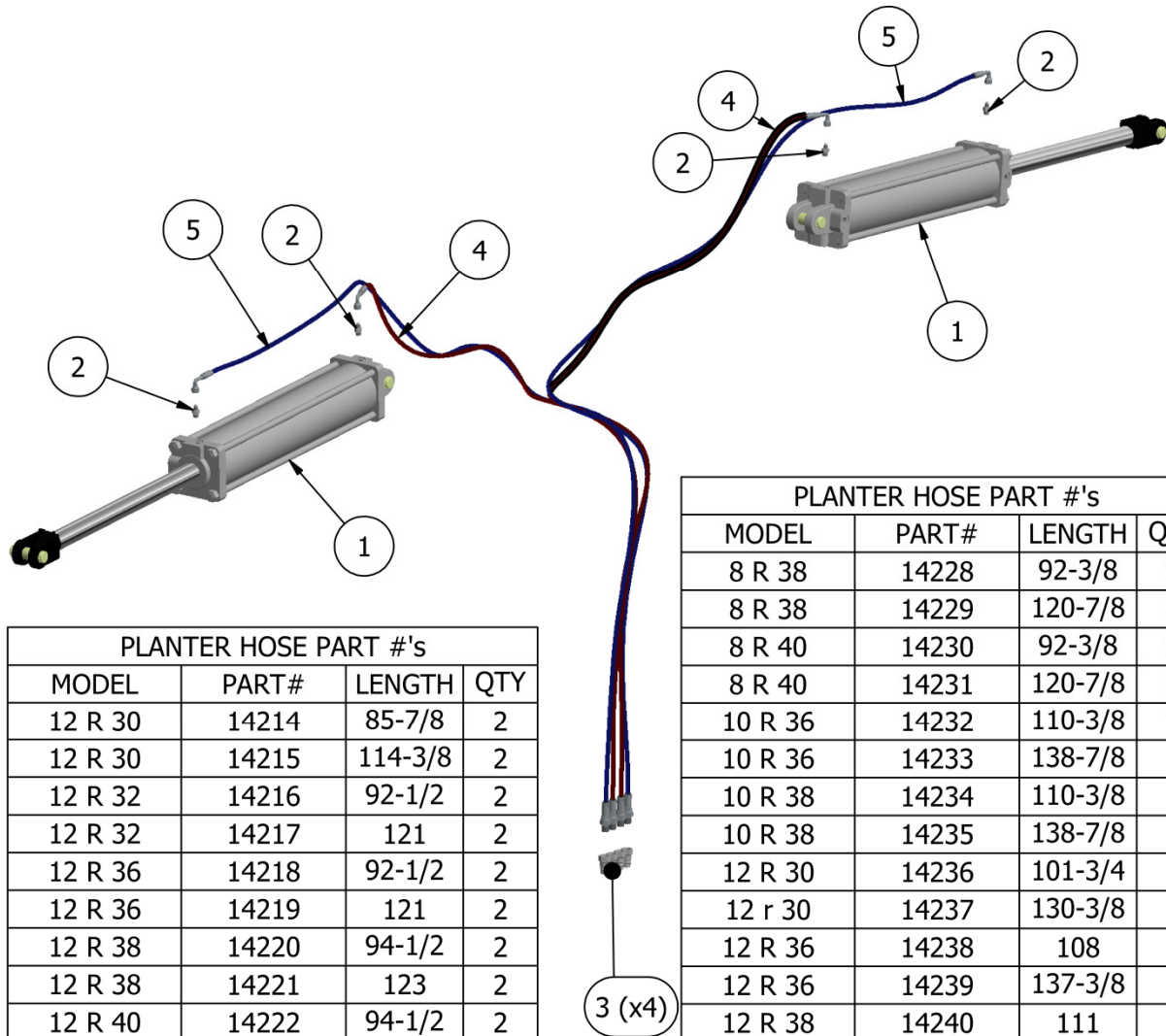

PLANTER HOSE PART #'s			
MODEL	PART#	LENGTH	QTY
12 R 30	14214	85-7/8	2
12 R 30	14215	114-3/8	2
12 R 32	14216	92-1/2	2
12 R 32	14217	121	2
12 R 36	14218	92-1/2	2
12 R 36	14219	121	2
12 R 38	14220	94-1/2	2
12 R 38	14221	123	2
12 R 40	14222	94-1/2	2
12 r 40	14223	123	2
16 R 30	14224	96-1/2	2
16 R 30	14225	125	2
16 R 36	14226	123-3/4	2
16 R 36	14227	152-3/8	2

PLANTER HOSE PART #'s			
MODEL	PART#	LENGTH	QTY
8 R 38	14228	92-3/8	2
8 R 38	14229	120-7/8	2
8 R 40	14230	92-3/8	2
8 R 40	14231	120-7/8	2
10 R 36	14232	110-3/8	2
10 R 36	14233	138-7/8	2
10 R 38	14234	110-3/8	2
10 R 38	14235	138-7/8	2
12 R 30	14236	101-3/4	2
12 r 30	14237	130-3/8	2
12 R 36	14238	108	2
12 R 36	14239	137-3/8	2
12 R 38	14240	111	2
12 R 38	14241	140-3/8	2
12 R 40	14242	113-3/8	2
12 R 40	14243	141-7/8	2
15 R 30	14244	139-7/8	2
15 R 30	14245	168-3/8	2

ITEM	PART #	DESCRIPTION	QTY	ITEM	PART #	DESCRIPTION	QTY
1	16090	5" x 24" Cylinder	2	4		SEE ABOVE CHARTS	2
2	14028	10 Boss Oring to 6 JIC Adapter	4	5		SEE ABOVE CHARTS	2
3	12649	8 O-ring Pioneer Fitting	4				

FRONT TOOLBAR

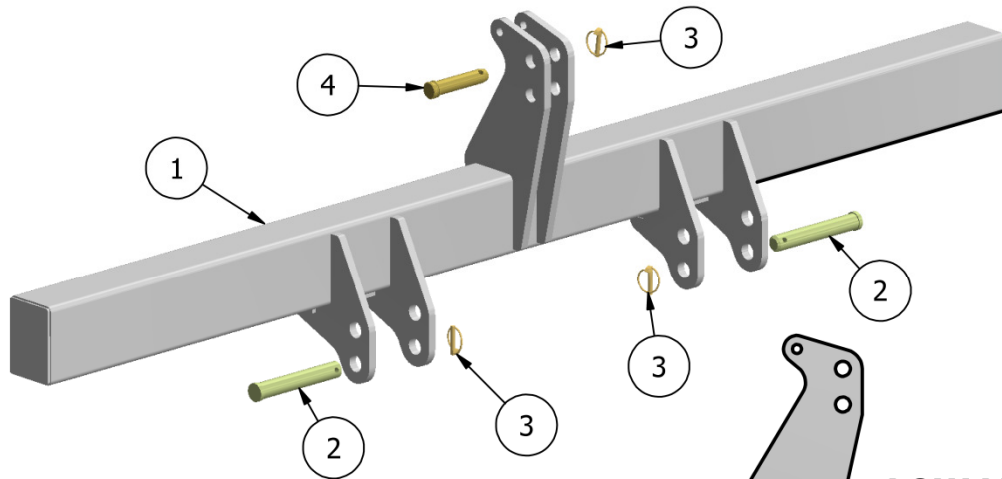

ITEM	PART #	DESCRIPTION	QTY
1		SEE CHARTS BELOW	1
2	90114	Cat 3 pin	2
3	90116	Lynch Pin 7/16" x 1-3/4"	3
4	11200	Cat 3 Top Link Pin	1

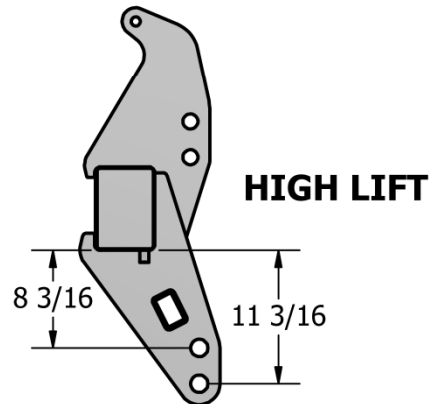
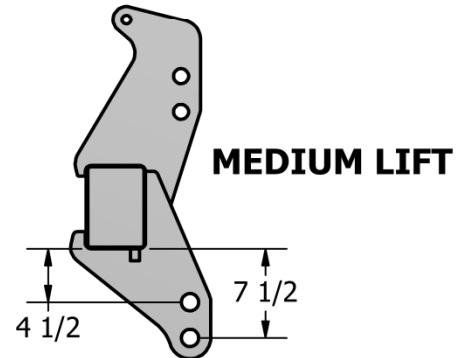
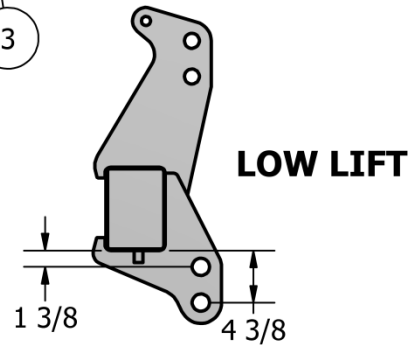

FRONT BAR PART #'s			
LENGTH "	LOW LIFT	MEDIUM LIFT	HIGH LIFT
90	14246	14251	17880
110	16405	16409	17444
144	16306	16410	17340
156	14247	14252	17883
168	16537	16411	17445
180	16538	14253	17885
192	16407	16413	17446
210	16539	14254	17887
216	16541	16414	17447
240	16542	16543	17448
264	14248	17891	14255
288	14249	17893	14256
300	14250	17895	14257

11853

4" TOOLBAR CLAMP

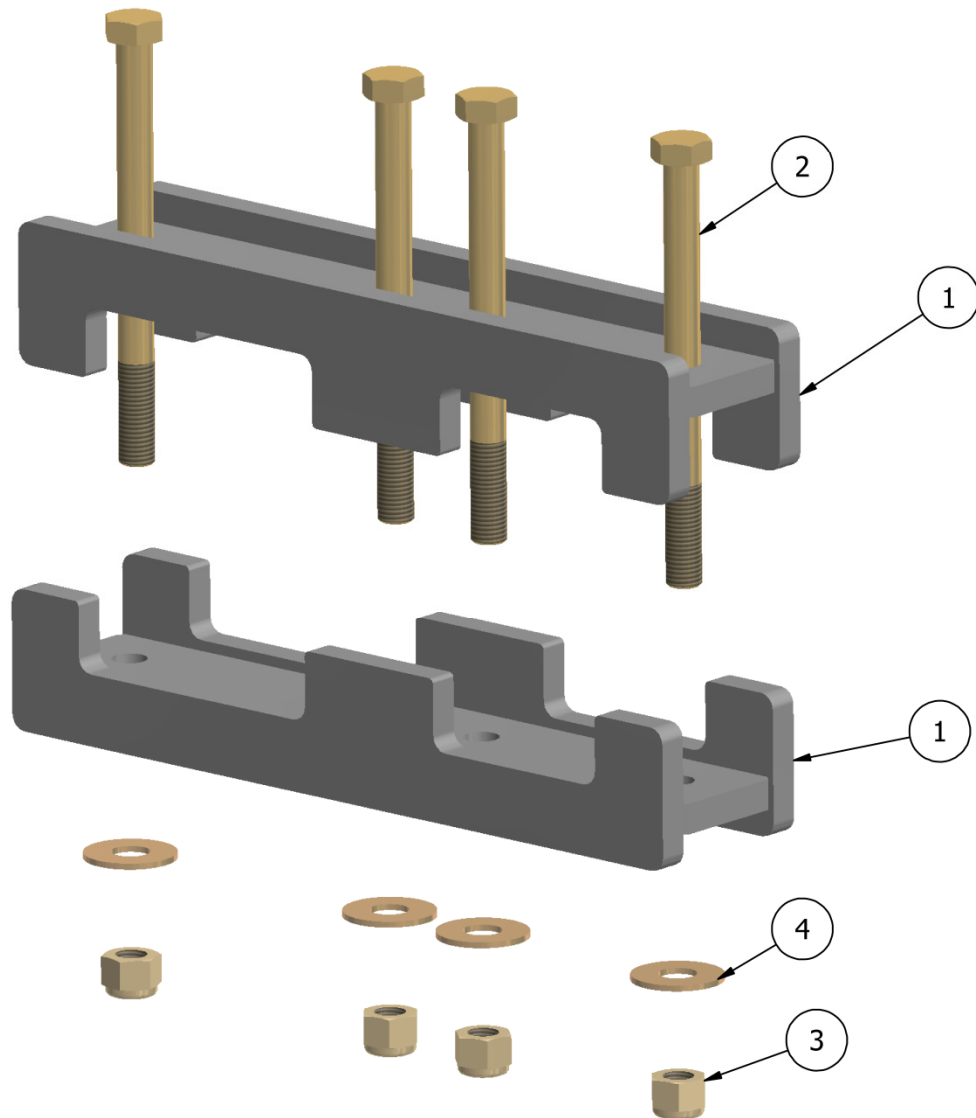

QTY	PART #	DESCRIPTION	ITEM	ITEM	PART #	DESCRIPTION	QTY
2	14799	Toolbar Clamp	1	3	14440	Nut .875 Nylock Gr 8	4
4	14430	Bolt .875 x 10.5 gr 8	2	4	14450	Washer .875 gr 8	4

TIEBACK ASSEMBLY

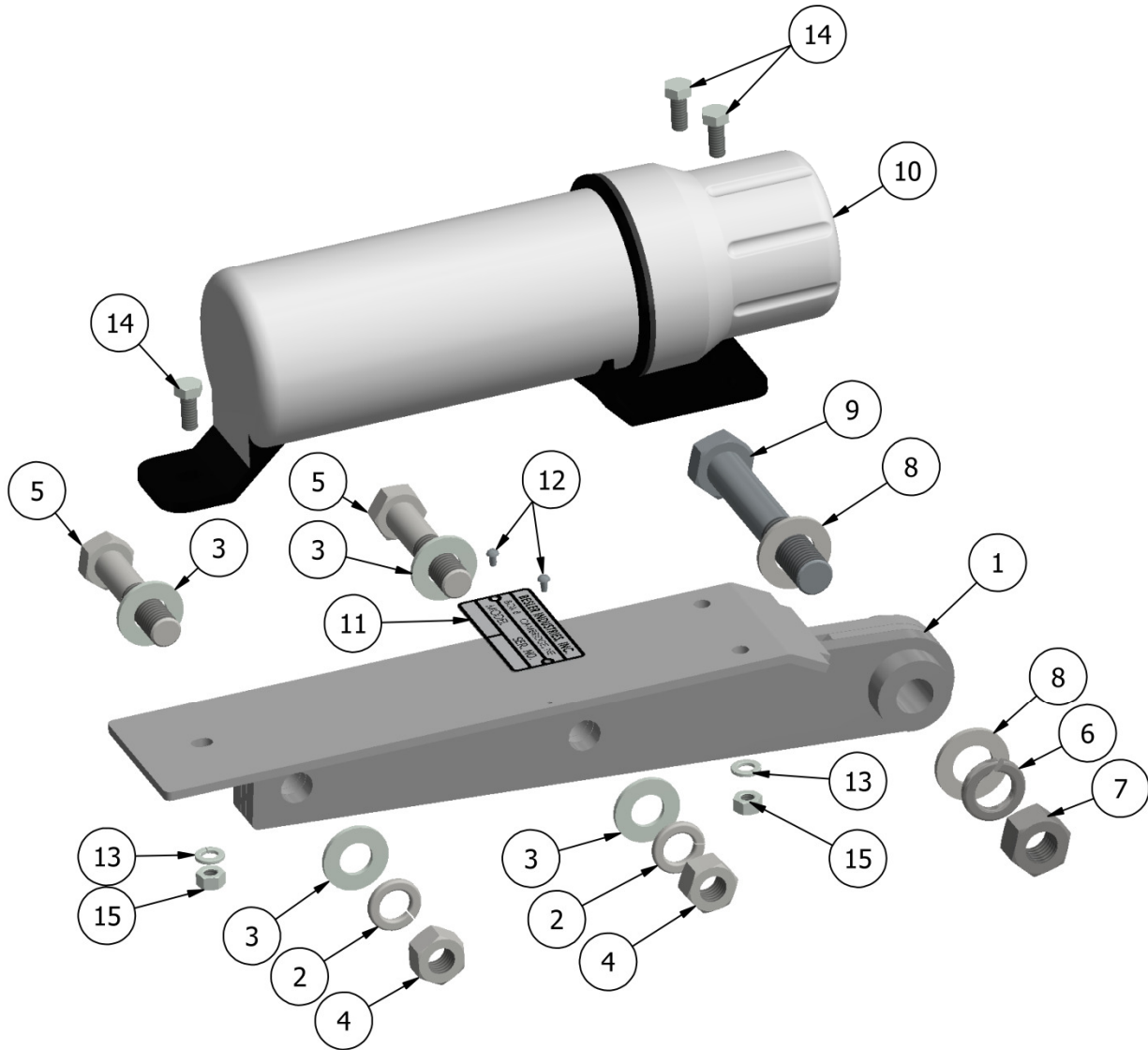

ITEM	PART #	DESCRIPTION	QTY	ITEM	PART #	DESCRIPTION	QTY
1	17424	Tieback Weldment	1	9	90352	3/4" x 4-3/4" Bolt	1
2	90123	5/8" Lock Washer	2	10	11641	Owners Manual Holder	1
3	90124	5/8" Flat Washer	4	11	10898	Serial Number Plate	1
4	90137	5/8" Nut	2	12	10292	#6 x 1/4" Drive Rivet	2
5	90151	5/8" x 3" Bolt	2	13	90106	.312 Lock Washer	3
6	90158	3/4" Lock Washer	1	14	90107	Bolt .312 x .75	3
7	90160	3/4" nut	1	15	90253	5/16" Nut	3
8	90167	Flat Washer 3/4"	2				